

7. Fix the dial

1. Set the torque wrench to 2.5m-kgs and fasten the screw. Please make sure the screw is fastened in vertically

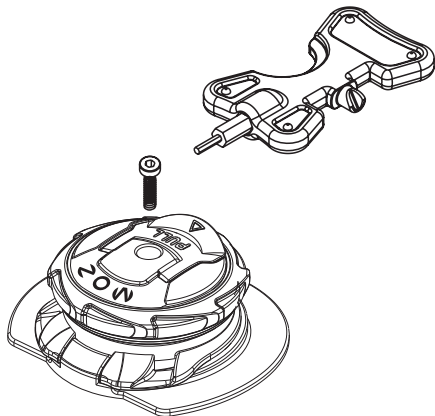

8. Testing

1. Tighten the wire lace in clockwise
2. Push up the pull button to release
3. Pull out the wire lace inside the base
4. Repeat the above steps three times, tightening and releasing the wire lace until it runs smoothly

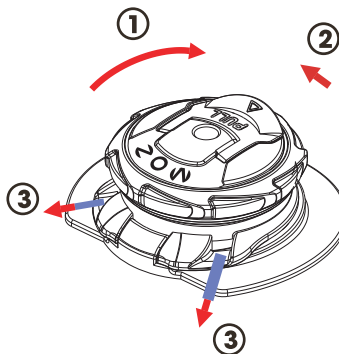

O'NEAL

ASSEMBLED MANUAL A-A22

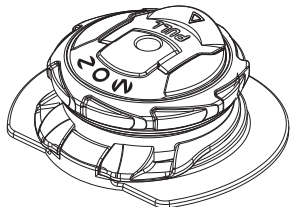

www.oneal.eu
www.oneal.com

1. Thread the wire lace into the holes of the base

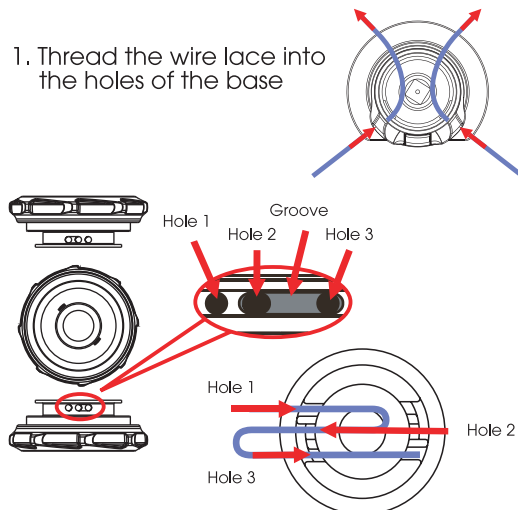

2. Thread the wire lace into the reel holes in the order of hole 1 → hole 2 → hole 3

3. Tighten the wire lace to fix in place

FIG.1

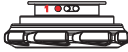
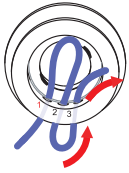

FIG.2

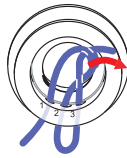

FIG.3

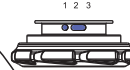
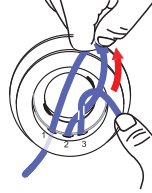

FIG. 1
STEP: Hole 1 → Hole 2 → Hole 3

FIG. 2
Thread wire terminal through the loop between hole 1 & hole 2

FIG. 3
Keep your finger pressed on the wire terminal, pull the loop to make place the wire into the groove

FIG. 4
Pull wire tightly from hole 1

FIG 4

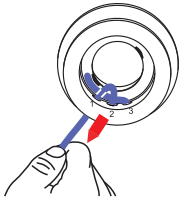

FIG 5

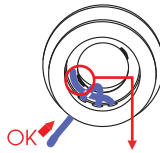
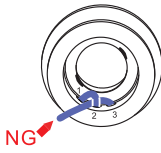

FIG.6

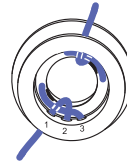
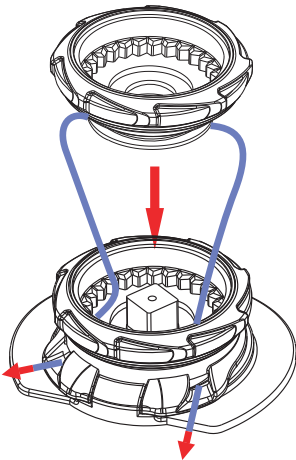

FIG. 5
Don't let the wire come out from hole 2. Ensure the end of the wire sticks in the protruding spot or it will influence the functionality of the whole system

FIG. 6
Thread wire terminal into the loop between hole 1 & hole 2, keep wire terminal inward

Let the end of the wire stuck in the protruding spot.

4. Pull the lace toward outside and put the reel into the base



5. Inserting the dial cover

1. Position the base's outlet holes to the upper side
2. After setting up the reel, make sure the dial's cover, with the words up, is in the same directions as the base
3. Align the centre pole then press down the cover with a clear click sound to confirm correct assembly

